

★ ★ ★ ★ SUP

Sercotel Sorolla Palace

Deluxe Collection Hotel



Sercotel Sorolla Palace 4* SUP

SINGULARITY, ELEGANCE AND VERSATILITY

Sercotel
hotels

★ ★ ★ ★ SUP

Sercotel Sorolla Palace

Deluxe Collection Hotel

Sercotel
hotels



WELCOME

Sercotel Sorolla Palace is a 4* superior hotel located right next to the Congress Palace of Valencia. With excellent connections to the key points of the city and fantastic facilities, is the ideal option for your leisure, business, meeting, or convention trip in the capital of the river Turia.



FLIGHT CONNECTIONS

- Connected with the main Spanish capitals
- Excellent connections with the main European airports



DISTANCE TO MAIN INTEREST POINTS



Congress Palace 100m



Sercotel Sorolla Palace 4*SUP



Fair 4,3km



Ciudad de las Artes y las Ciencias 7km



Old Town 3,8km



Beach 10km



Harbor 8km



Biopark 2,8km

TRANSPORT



VALENCIA AIRPORT

- 8.9 km from the hotel
- Main Spanish cities
- Main European airports



UNDERGROUND

- Beniferri station 500 m

TRAM

- Empalme station 500 m

EMT BUS

- Line 99 right at the entrance of the hotel

JOAQUÍN SOROLLA TRAIN STATION

- 3 km from the hotel
- AVE connection
- High and middle speed trains
- Regional trains

LOCAL TRAINS STATION

- 3.5 km from the hotel





HOTEL SERVICES

- Free wi-fi
- Business center
- Car rental
- Laundry services
- Dry cleaner service
- Access for people with reduced mobility
- Private parking
- Pillow menu
- Restaurant service
- Snack bar service
- 24-hour room service
- Cloakroom service
- 24-hour reception
- Electric bikes rental



HOTEL FACILITIES

- Terrace / Solarium
- Gym
- Sauna
- Jacuzzi
- Parking
- Business corner
- Cafeteria
- A la carte restaurant
- Swimming pool (heated and covered in spring, autumn and winter)
- Squash court



OUR BEDROOMS

- 215 standard bedrooms
- 34 superior bedrooms
- 12 superior junior suites
- 9 junior suites
- 1 suite Sorolla





OUR BEDROOMS

- Minibar
- 24-hour room service
- Free safe box
- Free wi-fi
- Individual air conditioning
- Desk
- Wardrobe
- Worktable
- Private bathroom
- TV Satellite
- Background music
- Phone line
- Pillow menu
- Etc.

CAFETERIA **L'ESTANY**

- Open bar area
- Cafeteria menu
- Cafes and cocktails menu
- Open every day until 1 am





OUR TERRACE

- Swimming pool (heated and covered in spring, autumn and winter)
- Outdoor terrace
- Solarium
- Jacuzzi
- Snack bar



SPORT FACILITIES



GYM

- Natural light
- Fully equipped
- Locker room
- Sauna
- TV

SQUASH COURT

- On the terrace
- Glazed Enclosures



THE BEST MEDITERRANEAN GASTRONOMY



WIDE VARIETY OF SPACES



RESTAURANT EL DOSSEL

- Panelable restaurant in three independent spaces
- 3 private independent spaces of 10 people per room
- Restaurant maximum capacity of 70 people
- Breakfast buffet with a capacity of 220 people
- A la carte service for individuals and groups
- Maximum capacity for the whole floor is 220 people





BUFFET AREA

- Breakfast buffet
- Buffet area for lunch and dinner
- Maximum capacity of 120 people
- Possibility of increasing the capacity using the restaurant located on the same floor. Maximum capacity of 220 people









GALA DINNERS

- 1094m2
- Cocktail maximum capacity of 900 people
- Banquet maximum capacity of 600 people
- Possibility Open Bar, disco
- Panelable in two independent meeting rooms
- Natural Light
- Exclusivity



12 MEETING ROOMS

							
El Perellonet	24	27	20	30	45	21	54
Las Arenas	24	27	20	30	45	21	55
El Brosquil	20	21	20	25	40	15	49
Les Palmeretes	24	27	20	30	45	21	55
Pinedo	12	18	15	20	25	18	41
El Faro	20	24	10	20	40	18	55
El Racó	24	18	10	20	36	18	56
Almardá	12	12	10	20	25	9	39
La Goleta	-	45	25	80	80	30	105
Recatí A	300	250	60	600	400	60	748
Recatí B	140	140	45	300	220	50	346
Perellonet+Arenas	48	42	27	60	80	27	109
Palmeretes+Brosquil	44	42	27	55	80	27	104
Pinedo+Faro	32	36	20	40	60	27	96
Racó+Almardá	24	30	20	40	60	21	95
Gran Pinedo	72	72	30	100	120	33	120
Gran Salón Recati	600	450	-	900	700	62	1094

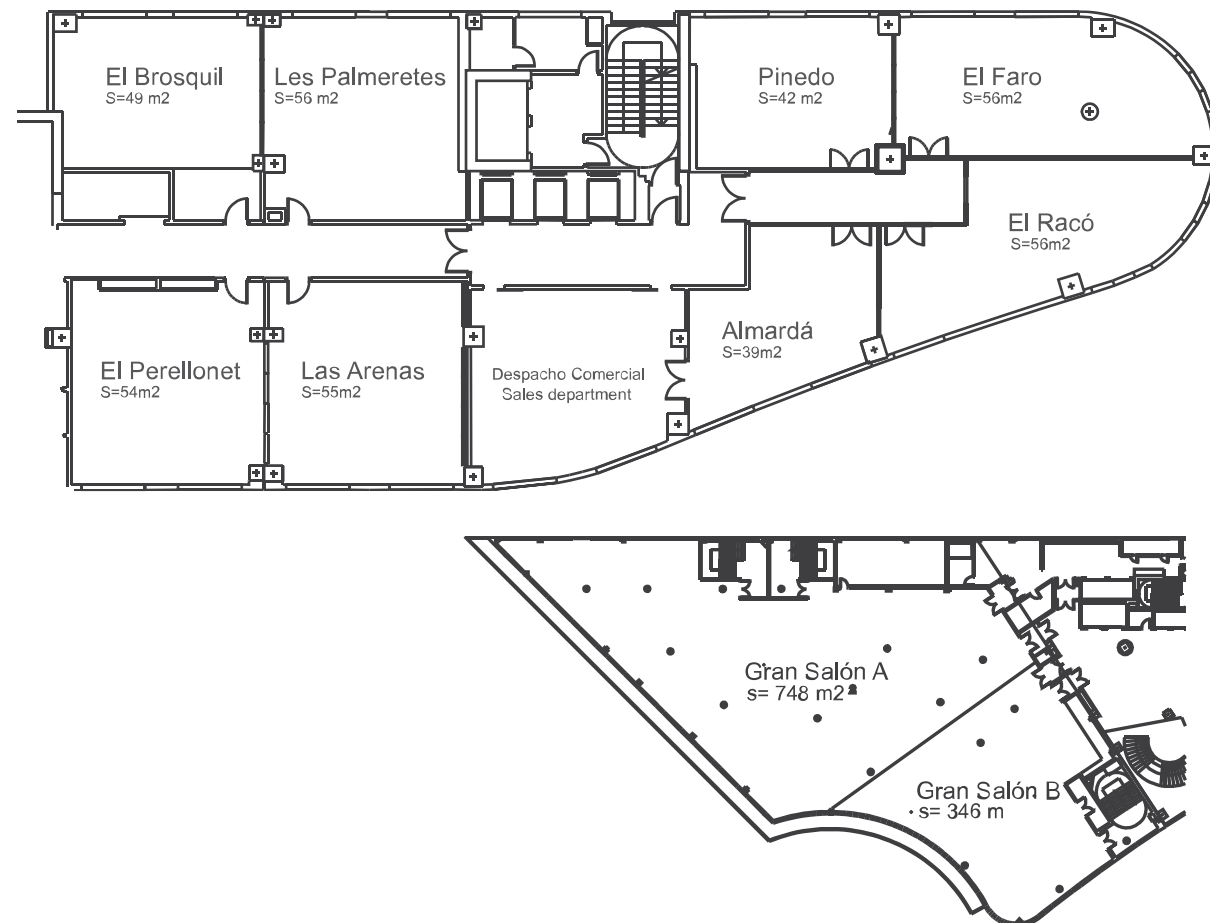



2 PLENARY ROOMS

- **Recatí A:** 748 m2. maximum capacity 400 people in theater set-up
- **Recatí B:** 346 m2. maximum capacity 220 people in theater set-up
- **Total:** 1094m2. maximum capacity 700 in theater set-up
- Independent hall for commercial exhibitions, Cocktails, Coffee breaks...

COMMERCIAL EXHIBITION ZONE

- Independent hall in front of plenary rooms
- Exclusivity
- Natural light
- 250m2
- Area for Coffee breaks, Cocktails...
- Commercial exhibitions areas (maximum 13 stands 3x2 with coffee points)
- Poster exhibition zone
- Technical secretary zone





SUB-COMMISSION ROOMS

- 8 sub-commission rooms all in the same floor
- VIP room on floor 14th
- Natural light
- Fully equipped
- Screen and projector in the room (*)

(*) Check about supplement

★ ★ ★ ★ SUP

Sercotel Sorolla Palace

Deluxe Collection Hotel

Sercotel
hotels

WE WISH TO SEE YOU SOON!

Avenida de las Cortes Valencianas, 58 46015 Valencia

T. 961 868 702

vsales@hotelsorollapalace.com

www.hotelsorollapalace.com

